

## 7x5 OVERLAP APEX SHED PARTS LIST (4LA75DDNWM) - NO WINDOWS

### FLOOR PLAN

Please take note of the corner position, as this indicates the panel orientation during construction. This will apply to all of the corners for your chosen shed.

Same size panels are interchangeable. Hinge your door onto either side.

- **A** — 1ft Panel (295 x 1831mm)
- **B** — 3ft Panel (885 x 1831mm)
- **C** — 4ft Panel (1180 x 1831mm)
- **D** — 4ft Door Panel (1180 x 1831mm)

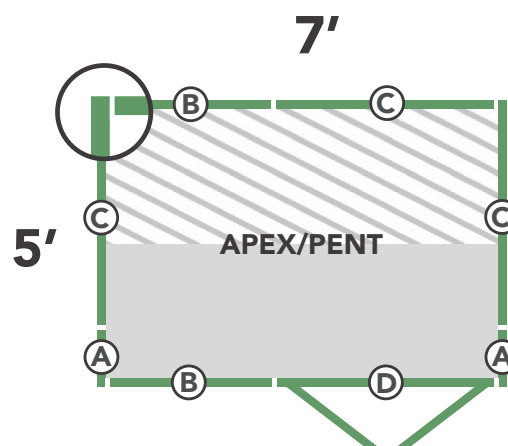

### CHECK YOU HAVE ALL YOUR PARTS PRIOR TO ASSEMBLY

The parts do not have codes on them. They are listed below should you need to order one. The components provided may be heavy. Please lift with caution and with a minimum of 2 people.

7x5 Overlap Pressure Treated Double Door Apex Shed - No Windows (4LA75DDNWM)			
Label	Part Code	Description	Qty
1	MSBFL257	Floor (737x2121mm)	2
2	4L295PP	1ft Plain Panel (295x1831mm)	2
3	4L885PP	3ft Plain Panel (885x1831mm)	2
4	4L1180PP	4ft Plain Panel (1180x1831mm)	3
5	SPMS1180DDP	4ft Door Panel (1180x1831mm)	1
6	4LPEA7	Apex Section (2135x429mm)	2
7	28161088PT	Door Strip (28x16x1088mm)	1
8	P40121823PT	Cover Strip (40x12x1823mm)	8
9	38121710PPT	Door Weather Strip (38x12x1710mm)	2
10	37281417KDPT	Roof Beam (37x28x1417mm)	4
11	OSB150712148	OSB Roof Sheet (1507x1214x8mm)	2
12	28281507PT	Roof Strip (28x28x1507mm)	2
13	P59121200PT	Fascia's (59x12x1200mm)	4
14	FIN23214212PT	Finial (232x142x12mm)	2
15	MSPDDR	Door (537x1692mm)	2
16	45281640PT	Slamming Strip (45x28x1640mm)	1

Felt - Please contact our aftersales team with your product code if you are missing your felt.

Use the labelled components on the next page to help identify the part code and description.

1

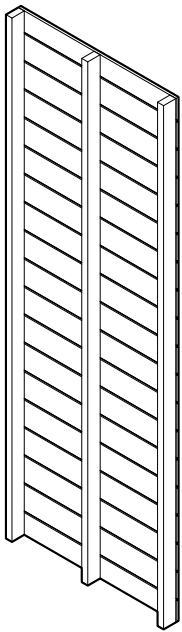

2

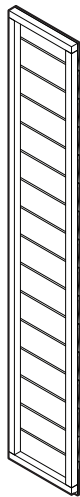

3

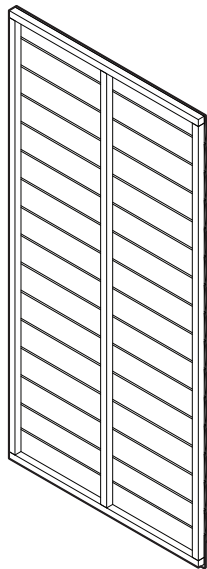

4

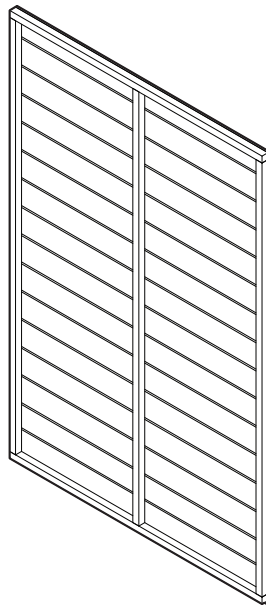

5

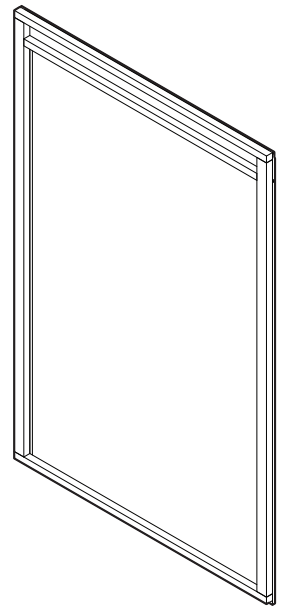

6

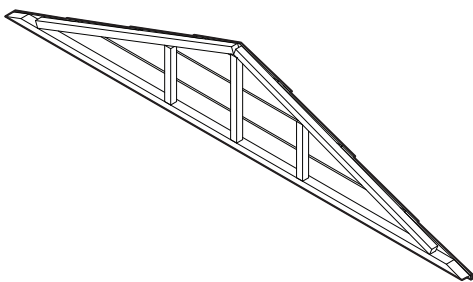

7



8



9



10



11

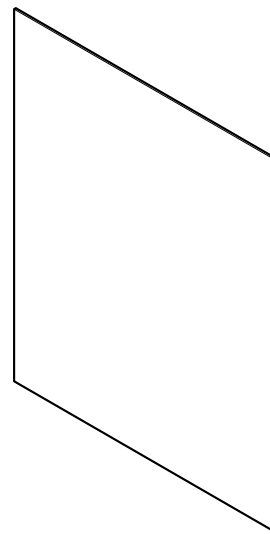

12



13



14



15

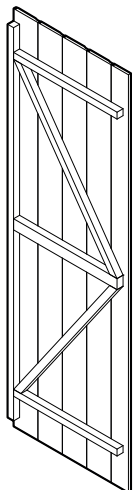

16

